





Handwritten text at the top of the page, possibly a title or header.

Main body of handwritten text, appearing to be a list or series of entries, possibly in a non-Latin script.



*Handwritten signature or scribble*

100

Handwritten text at the top of the page, possibly a title or header.

Handwritten text in the upper right section of the page.

Handwritten text in the upper right section of the page.

Handwritten text in the upper right section of the page.

Handwritten text in the upper right section of the page.

Handwritten text in the upper right section of the page.

Handwritten text in the middle section of the page.

Handwritten text in the middle section of the page.

Handwritten text in the middle section of the page.

Handwritten text in the middle section of the page.

Handwritten text in the middle section of the page.

Handwritten text in the middle section of the page.

Handwritten text in the middle section of the page.

Handwritten text in the middle section of the page.

Handwritten text in the middle section of the page.

Handwritten text in the middle section of the page.

Handwritten text at the bottom of the page, possibly a footer or signature.

Handwritten text in the lower left section of the page.

Handwritten text in the lower left section of the page.

Handwritten text in the lower left section of the page.

Handwritten text in the lower left section of the page.

Handwritten text in the lower left section of the page.

Handwritten text in the lower left section of the page.

Handwritten text in the lower left section of the page.

810P

N/87-  
 or  
 11/17

Regd  
 Book No. 7  
 Vol. 3  
 Part 115 117  
 Being No. 168  
 For the year 19 57

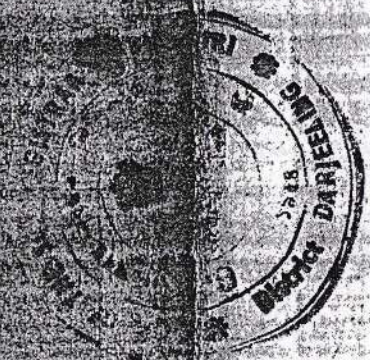

5.11.11  
 District Dairymaster  
 District Dairies

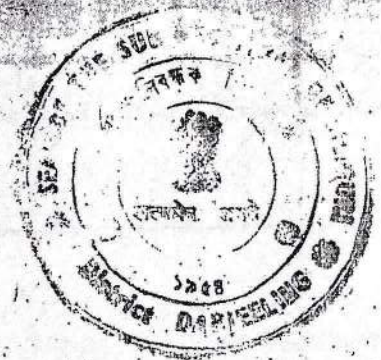

*Handwritten signature*

14.1.57

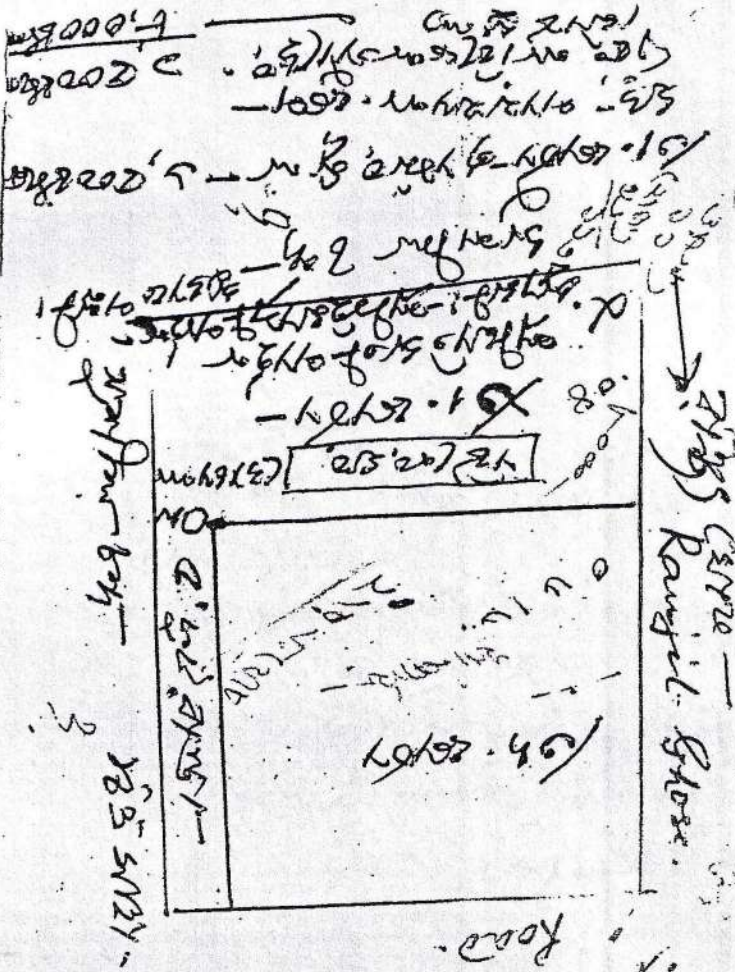

ଆମର ବିକ୍ରୟ ବାଣିଜ୍ୟ (ପୋସ)

Sikhan Basmi Ghosh.

ଆମର - ଅଗତ; ହିରୋସୁ ମାଧ୍ୟ (ପୋସ)

ଭେଦଭାବ କର

ଆମର - ବିକ୍ରୟ ମାଧ୍ୟ (ପୋସ)  
ସୁଭାଷ ମାଧ୍ୟ

ବାଧା ମିତ୍ର ମାଧ୍ୟ

ଆମର

ଆମ - ~~ବିକ୍ରୟ~~ ଆମର କର 8x6 = 2800

ଆମ ଭେଦଭାବ କର

= 5900  
32900